

MIT | Arts, Commerce & Science College

**Maharashtra Academy of Engineering and Educational
Research's**

**MIT Arts, Commerce and Science College, Alandi (D) –
412 105.**

7.1.5 Green Campus Initiatives –

Index

Sr. No	Heading	Page Number
1.	Landscaping with trees and plants i. Existing trees on site ii. Newly planted trees on site iii. New plantation layout iv. Quotation v. Site planning	3-7

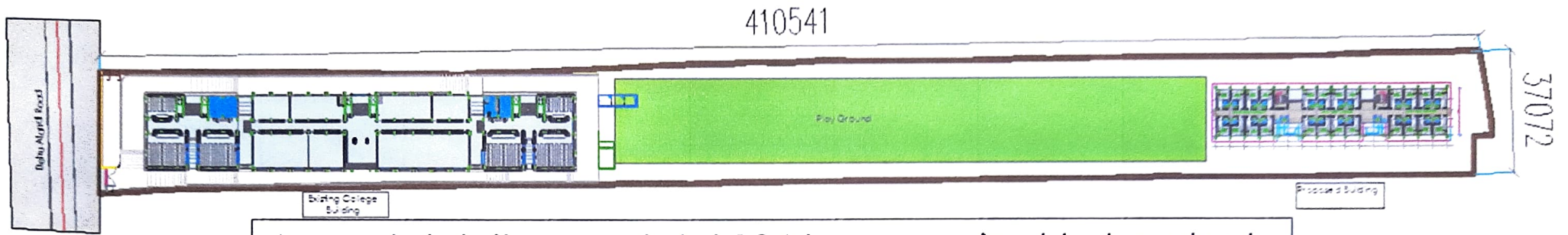

As per total site area total 184 trees required to be plant.

Existing trees on site -
 Phycus tree – 70 trees
 Badam – 1 tree
 Chafa – 1 tree
 Suru – 6 tree
 Umbar – 1 tree
 Pimple – 1 tree

Total – 90 trees
 already planted
 on site



Newly Planted
trees on Site
Total 155



New Plantation layout and plant list

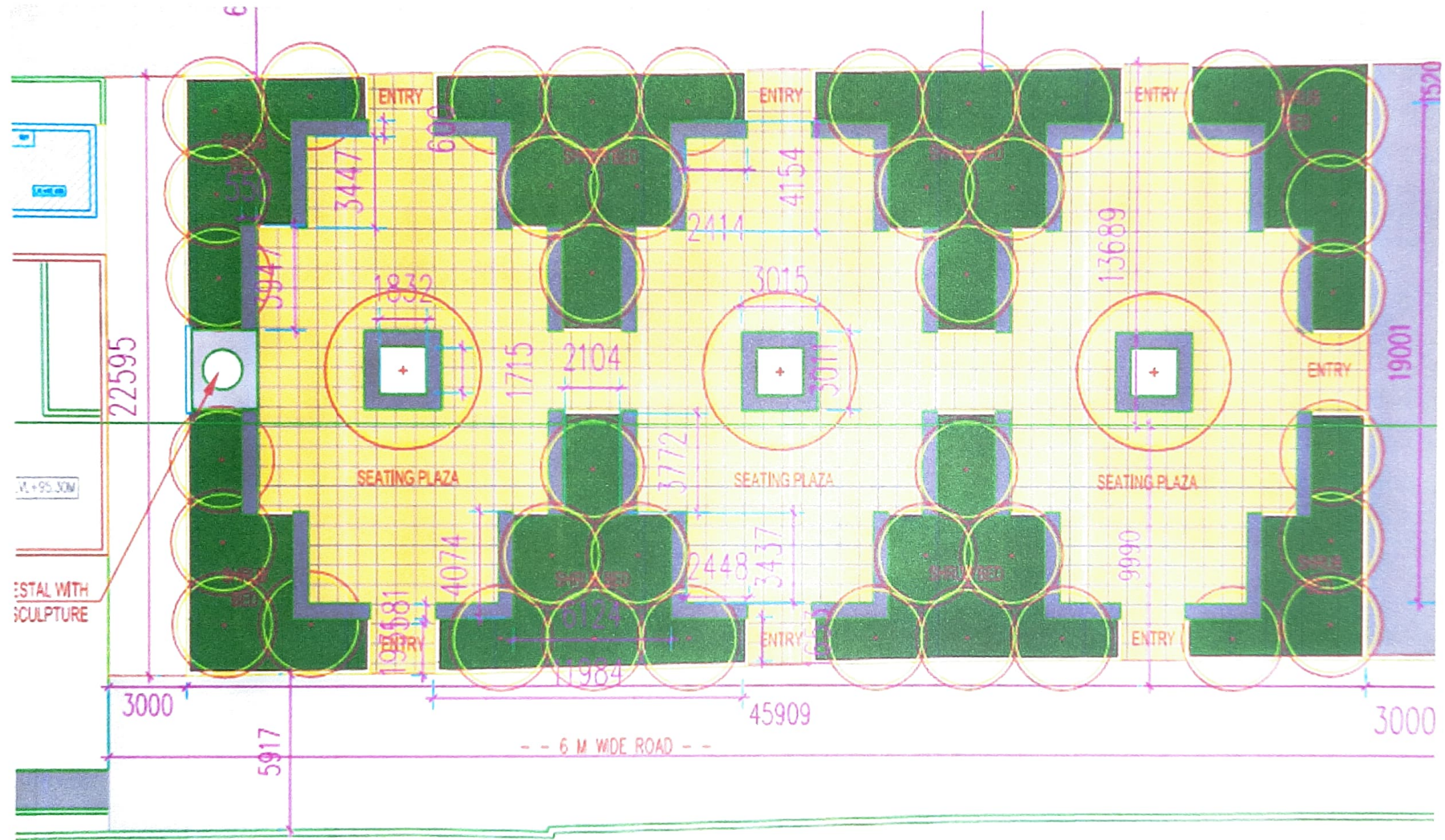

Quotation ordered for
new plantation

SHRI SAI LANDSCAPERS

Om Sai S no 45/1 baliraj colony Rahatani Pimpri Pune 17

Mo.9822507213 8551037171

Date: 09/12/2019

PLANTS QUOTATION TREES

No	Description	Length	Quantity	Rate per plant	Total
1	Bakul	10-12 ft	10	950.00	
2	Cassia fistula	10-12 ft	04	1050.00	
3	Khaya	10-12 ft	03	1050.00	
4	Bauhinia Blakema	10-12 ft	12	1050.00	
5	Pongamia Glabra	10-12 ft	04	950.00	
6	Lagerstroemia Flos Regina	10-12 ft	10	1000.00	
SHRUBS					
7	PlumbagoCapensis	0.45M c/c	340	15.00	
8	Mayna Erecta	0.45M c/c	310	15.00	
9	Dianella Grass	0.23M c/c	490	22.00	
10	Hemelia Pentas	0.30M c/c	100	15.00	
11	Spider Lily	0.30M c/c	1310	15.00	
12	Tagar Single	0.45M c/c	310	18.00	
Note=Transport Charges Extra					
50% Advance with purchase order					
Balance payment 10 days After Delivery					

Sr. No.	Points	Requirements as per standards and Facts on location	Remark/ Required
A Site Planning			
1	Soil Erosion Control	<ul style="list-style-type: none"> To control soil erosion concrete paving blocs are used. Pavers blocks are also endorse ground water seepage. Plantation is needs to be done along compound wall 	
2	Landscape	<ul style="list-style-type: none"> 3 courtyards are formed in between building, and are planted with various species . 1 tree for every 80 SQ M open area are required to plant on site. 185 trees need be plant through out site 	<ul style="list-style-type: none"> Prescribed number of trees are available on site. 